

SAMARITAN HOUSE RENOVATIONS

FIRST FLOOR PLAN

First Floor Renovations

 OVERALL INTERIOR RENOVATIONS

- UPGRADED HVAC SYSTEMS & CONTROLS
- NEW ROOM FINISHES
- NEW LIGHTING

 DONATIONS & DRY FOOD STORAGE

- RECONFIGURED CLOTHING & DONATION
- LARGER RECEIVING SERVICE AISLE
- ADDITIONAL DRY STORAGE ALONG WALL
- NEW STORAGE AREA SOUTH OF CLOTHING PROCESSING

 WOMEN'S EMERGENCY SHELTER

- EXPANDED WOMEN'S RESTROOM CAPACITY
- NEW NIGHT SUPERVISORY STAFF OFFICE

 EXPANDED CASE MGMT. /SHELTER OFFICES

- NEW CONFERENCE ROOM CONVERTS TO EMERGENCY BEDS @ NIGHT
- STAFF BREAK RM. RELOCATED TO 2ND FLOOR.
- NEW ENCLOSED OFFICES (4)
- NEW RECEIVING AREA
- NEW OXYGEN STORAGE
- NEW STAFF & GUEST RESTROOMS

 SHELTER RESTROOM EXPANSION

- ADD NEW TOILETS & PARTITIONS (8)
- PROVIDE NEW SHOWER STALLS (16) TOT.
- REMODELED LAUNDRY ROOMS
- NEW LOUNGE AREA

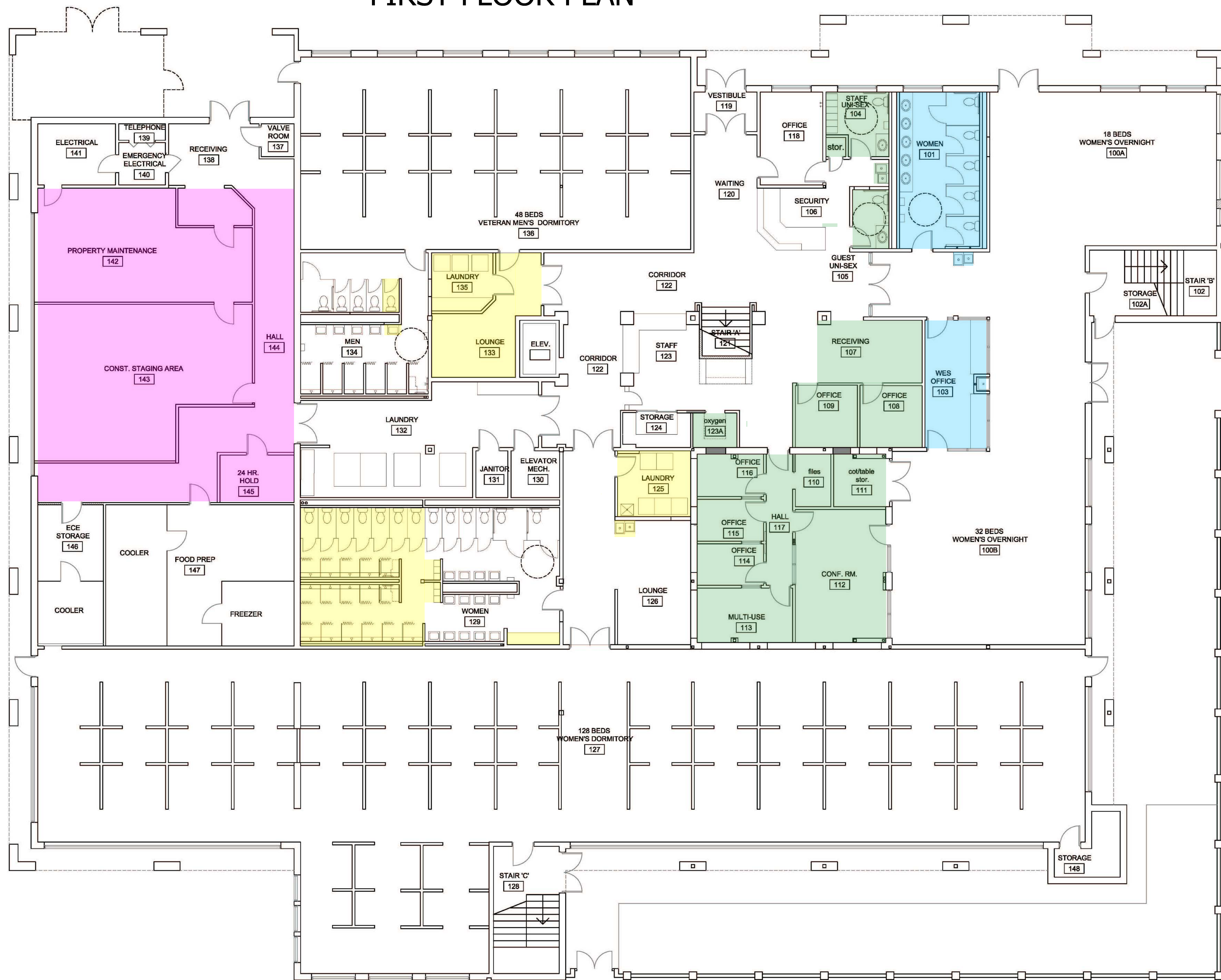

FIRST FLOOR PLAN

